

# Stapler-Folder Model 75

## Spare Parts List

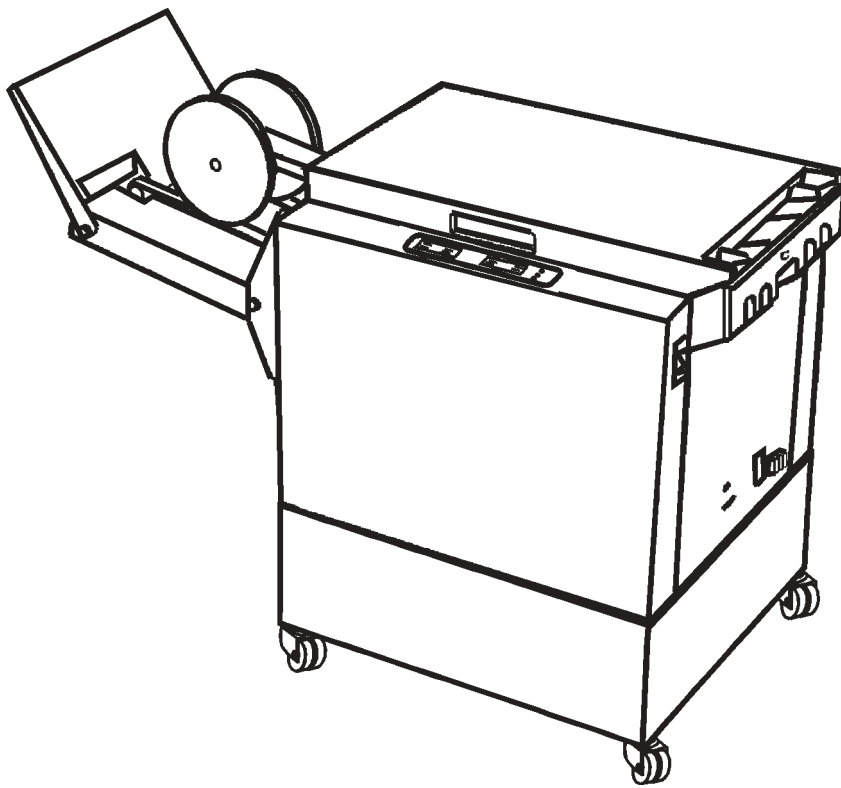

October 1996

Part no. 75381



---

<b><u>TITLE</u></b>	<b><u>PAGE</u></b>	<b><u>REVISION</u></b>
Outer view, Infeed	1.1	October-96
Outer view, Outfeed	1.3	October-96
Front view (cover removed)	1.5	October-96
Rear view (cover removed)	1.7	October-96
Infeed view (cover removed)	1.9	October-96
Infeed module assembly	1.11	October-96
Fold area	1.13	October-96
Stapler	1.15	August-96
Belt stacker	1.17	August-96

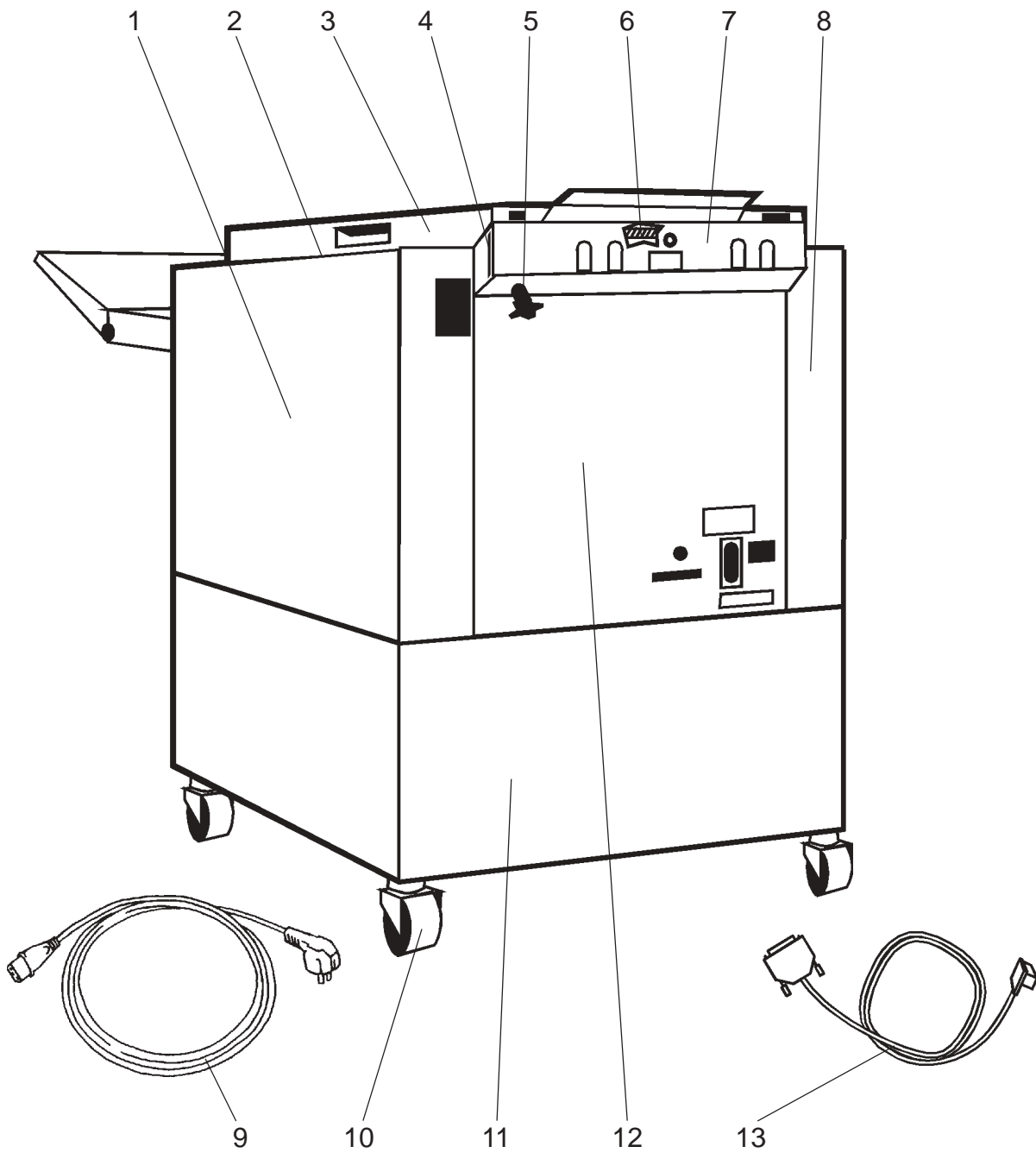

## Outer view, Infeed

T07011

---

Item	Part no.	Qty.	Description	Note
1	751045	1	Front cover assembly	
2	751047	1	Control panel assembly	
3	750161	1	Top cover assembly	Incl. 751002
	750145	1	Gas spring	
	751002	1	Upper infeed roller assembly	
	75154	2	Bushing, hinge	
4	61007	1	Label, green strip	
5	40711	1	Knob	
6	90169	1	Spring	
7	61163-26	1	Inner Docking plate	A4/A3 Machines.
	61164-26	1	Inner Docking plate	8.5x11"/11x17" Machines.
	61031-26	1	Outer Docking plate	A4/A3 Machines.
	61068-26	1	Outer Docking plate	8.5x11"/11x17" Machines.
8	751046	1	Rear cover assembly	
9	75275	1	Power Cord	230V Machines
	80175	1	Power cord	115V Machines
10	88465	4	Castor	
11	750002	1	Base	Incl. 88465
12	75300	1	Infeed cover	
13	750003	1	Connection cable	

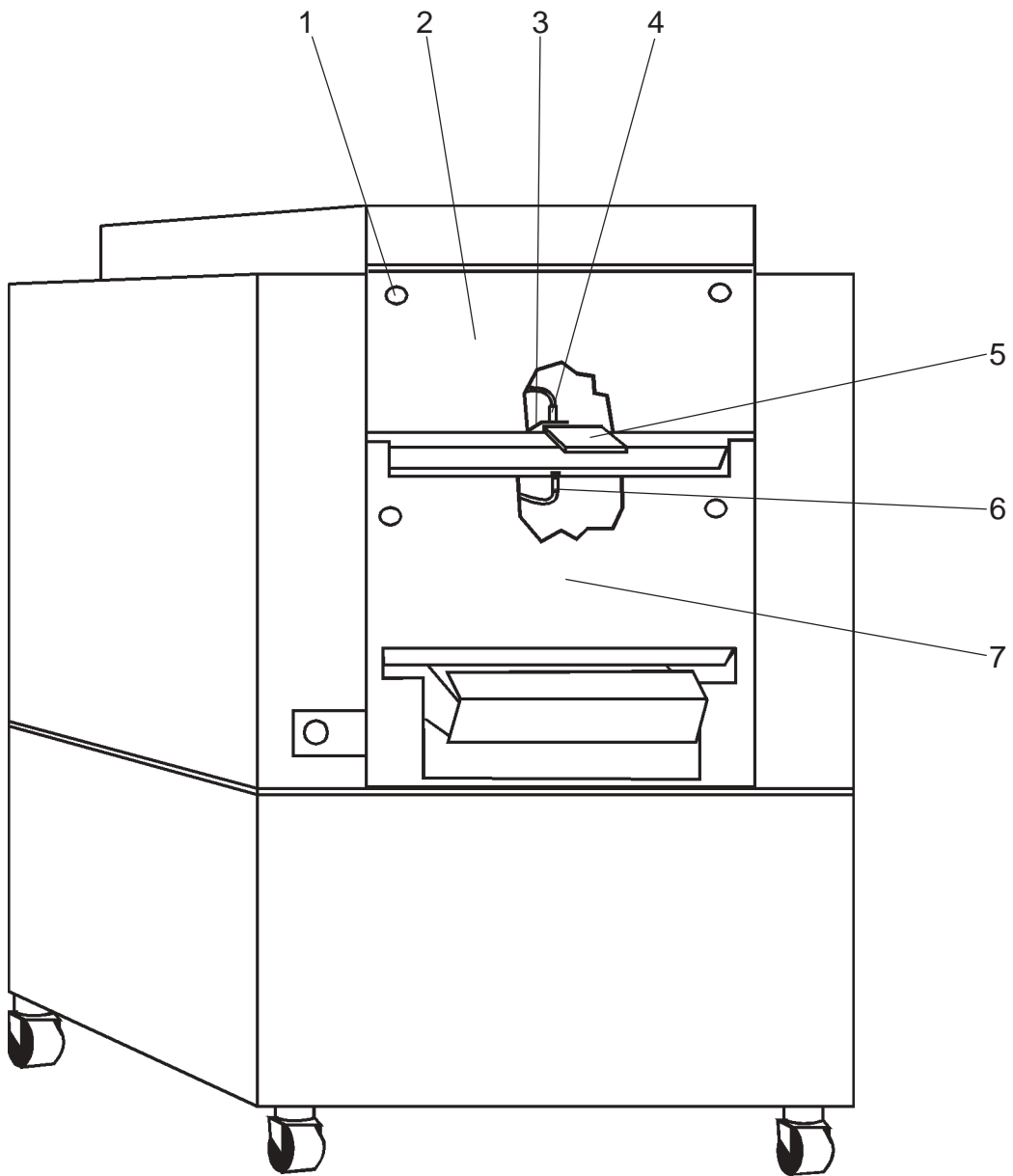

## Outer view, Outfeed

---

T07011

Item	Part no.	Qty.	Description	Note
1	88313	4	Bracket for stacker	
	22570	4	Plastic cap	
2	75003	1	Upper outfeed cover	
3	75120	1	Bracket, phototransistor	
4	881009	1	Phototransistor assembly	SEN 4
5	75153	1	Outfeed paper deflector	
	75316	1	Outfeed paper deflector for trimmer	
	89714	1	Plastic guide	
6	881008	1	LED assembly	
7	75012	1	Lower outfeed cover	

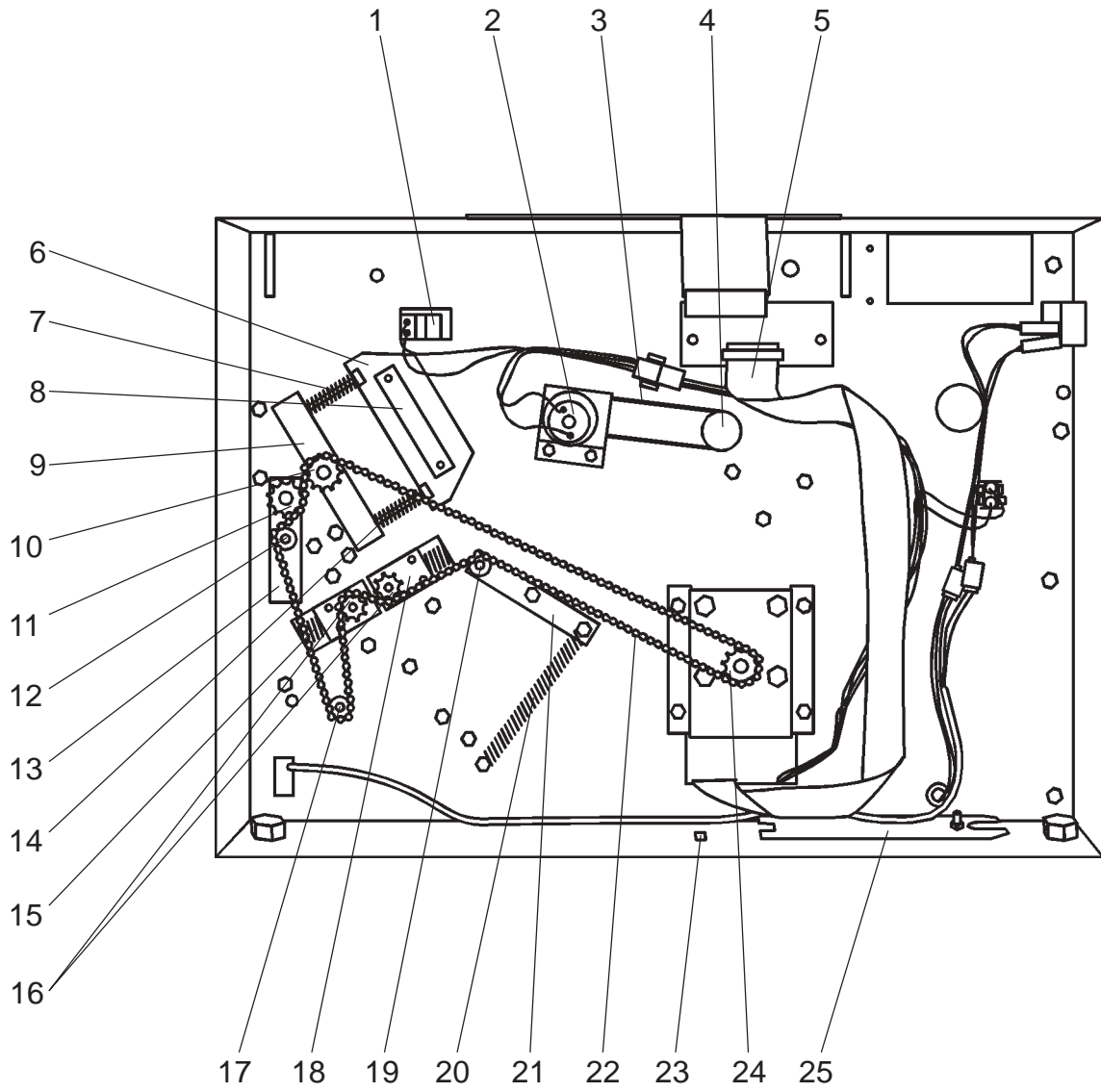

**Front view (cover removed)**

T07011

<b>Item</b>	<b>Part no.</b>	<b>Qty.</b>	<b>Description</b>	<b>Note</b>
1	88520	1	Set counter	
2	751053	1	Edge staple stop motor assembly	MOT 4
3	75341	1	O-ring	
4	75322	2	Pulley	
5	750216	1	Front panel extension assembly	
6	60623	2	Spring bracket	
7	60751	2	Spring	
8	60742	2	Nut plate	
9	603012	2	Spring loaded bearing block	Same part # front & rear Incl.60627
	60627	2	Needle bearing	
10	10543	1	Sprocket	
	75149	2	Bearing, plastic	Same part # front & rear
11	10543	1	Sprocket	
	60627	2	Needle bearing	Same part # front & rear
12	60535	1	Roller	
	60533	1	Shaft	
	60510	1	Retaining ring	
13	60628	2	Bearing block	Same part # front & rear
14	75301	2	Spring	
15	75090	4	Spring	
16	88826	2	Sprocket	
	60508	4	Flange bushing	
17	60535	1	Roller	
	60533	1	Shaft	
	60510	1	Retaining ring	
18	60621	4	Spring holder	
	60622	4	Spacer bracket	
19	60535	1	Roller	
	60533	1	Shaft	
	60510	1	Retaining ring	
20	60753	1	Spring	
21	750135	1	Chain tensioner	Including Item 19
22	60760	1	Chain	
23	75278	1	Stapler head alignment tool	
24	60534	1	Sprocket	
25	87017	1	Castor wrench	

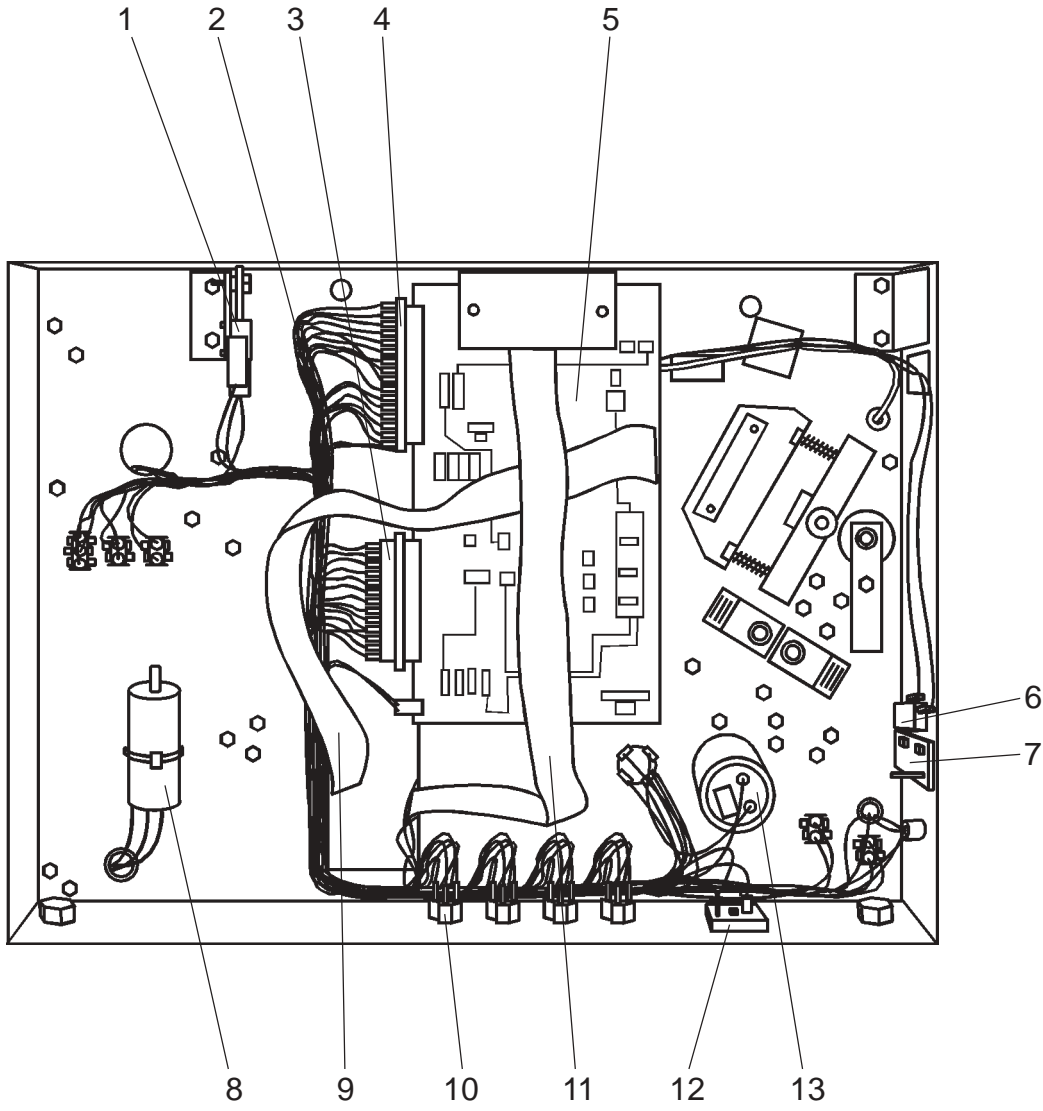

**Rear view (cover removed)**

T07011

<b>Item</b>	<b>Part no.</b>	<b>Qty.</b>	<b>Description</b>	<b>Note</b>
1	80652	1	Interlock switch	SW 5
	75154	2	Bushing, hinge	
2	750217	1	Main harness	Incl. Connectors & pins below Not included in 750217
	750218	1	Appendix harness	
	75188	1	Connector, 3-poles female	
	88479	2	Connector, 2-poles male	
	88478	9	Connector, 2-poles female	
	88264	6	Male pin	A male connector can consist of female pins and viceversa
	88265	19	Female pin	
	75230	1	Connector, 4-poles for SEN 3	
88267	4	Connector, 2-poles for LEDs		
3	86172	1	Connector, 32-poles	
	86171	32	Pin	
4	90334	1	Connector, 32-poles	
	90335	23	Pin	
5	751051	1	Controller printed circuit board	PCB PL75-1 19 mm.
	75190	4	Plastic pin, snap-in	
6	80652	1	Interlock bypass switch	SW 6
7	75022	1	Interlock bypass switch actuator	
	75044	2	Bushing	
8	751024	1	Filter assembly	FL 1
9	750203	1	Communication extension assembly	Incl. Interface receptacle
10	88492	5	Ground connector	
11	750216	1	Front panel extension assembly	
12	20711	1	Rectifier	REC 1
	88519	1	Insulator	
13	750205	1	Capacitor assembly	C 1

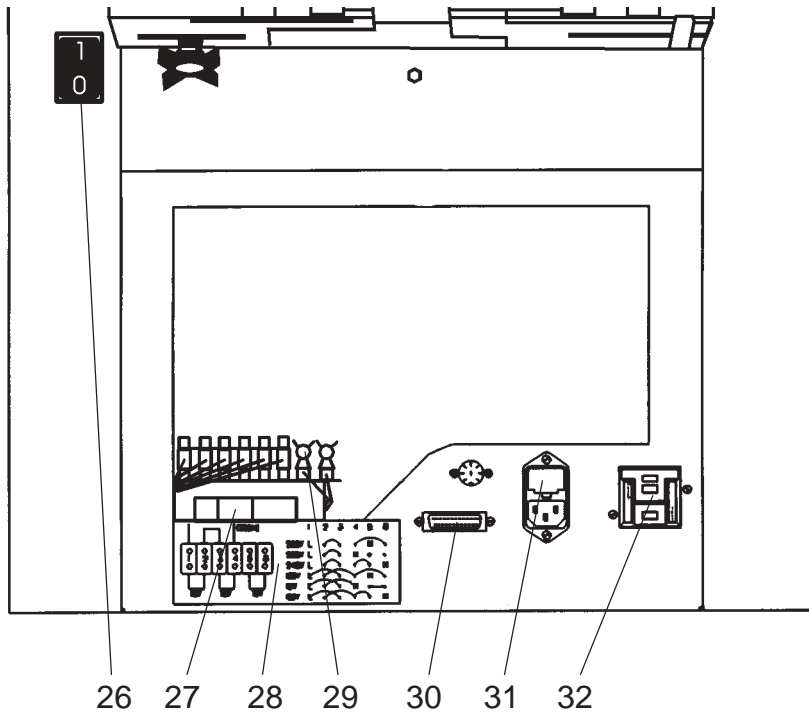
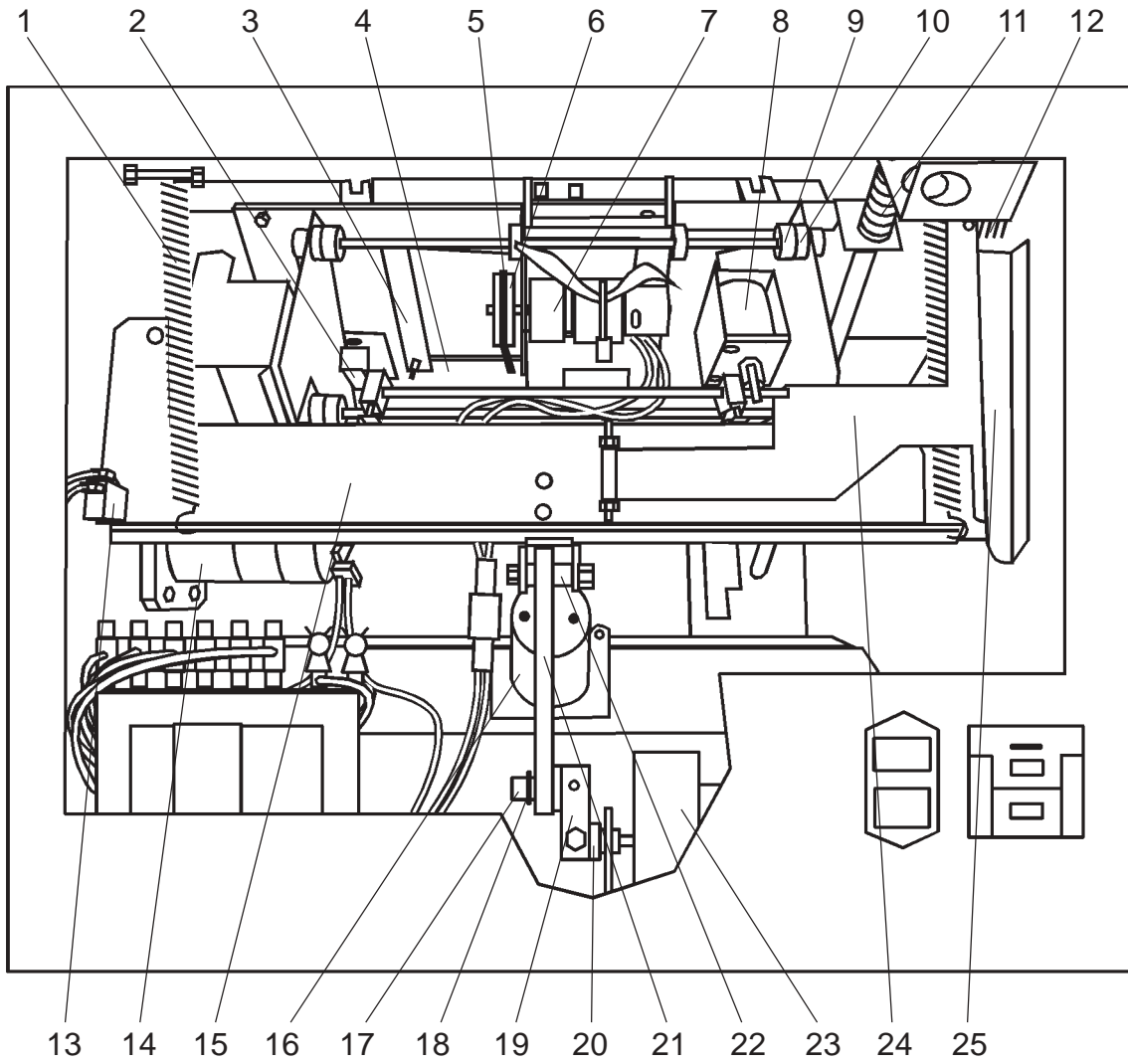

**Infeed view (cover removed)**

T07011

<b>Item</b>	<b>Part no.</b>	<b>Qty.</b>	<b>Description</b>	<b>Note</b>
1	61052	2	Spring	
2	751014	1	Staple stop gate release solenoid	SOL 2
3	75264	2	Stay, staple stop gate	
4	75019	1	Staple stop gate	
5	75341	1	O-Ring	
6	80744	1	Pulley	
7	750124	1	Stapled set transport motor assy.	MOT 2 Incl. Item 6
8	751017	1	Stapled set transport solenoid assy.	SOL 1
9	60852	4	Collar	
10	90146	2	Flange bushing	
11	75143	1	Threaded rod	
12	61050	1	Spring	
13	87083	1	Stapler home position switch	SW 1
14	751054	1	Folder rolls motor assembly	MOT 10
15	75209	1	Lower stapler bracket	
16	750131	1	Fold knife motor	MOT 9
17	60507	1	Crank journal	
18	60510	1	Retaining ring	
19	75164	1	Crank elbow	
20	90146	1	Flange bushing	
21	60505	1	Rod	
22	60894	1	Bushing	
23	750110	1	Stapler motor assembly	MOT 8
24	75210	1	Jogger linkage	
25	75211	1	Bracket, jogger linkage	
	750127	1	Jogger linkage assembly	Incl. 75210, 75211
26	60976	1	Main power switch	SW 7
27	75177	1	Transformer	T 1
28	75233	1	Jumper diagram label	
29	60519	2	10 VAC Fuse, 500mA	F2, F 3
30	750203	1	Interface receptacle	J 1 Incl. Ribbon cable
31	88570	1	Power receptacle	
	60651	1	Main power fuse, 3.15A	F 1, 230 V Machines
	88557	1	Main power fuse, 6,3A	F 1, 115 V Machines
32	88957	1	Ground fault interrupter	GFI

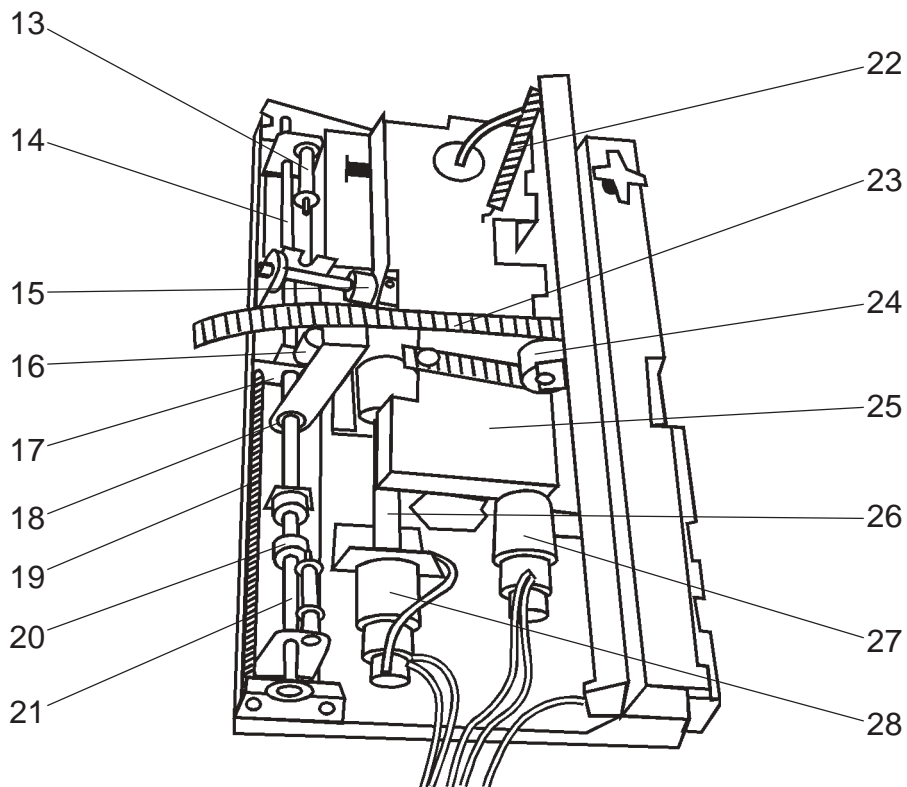
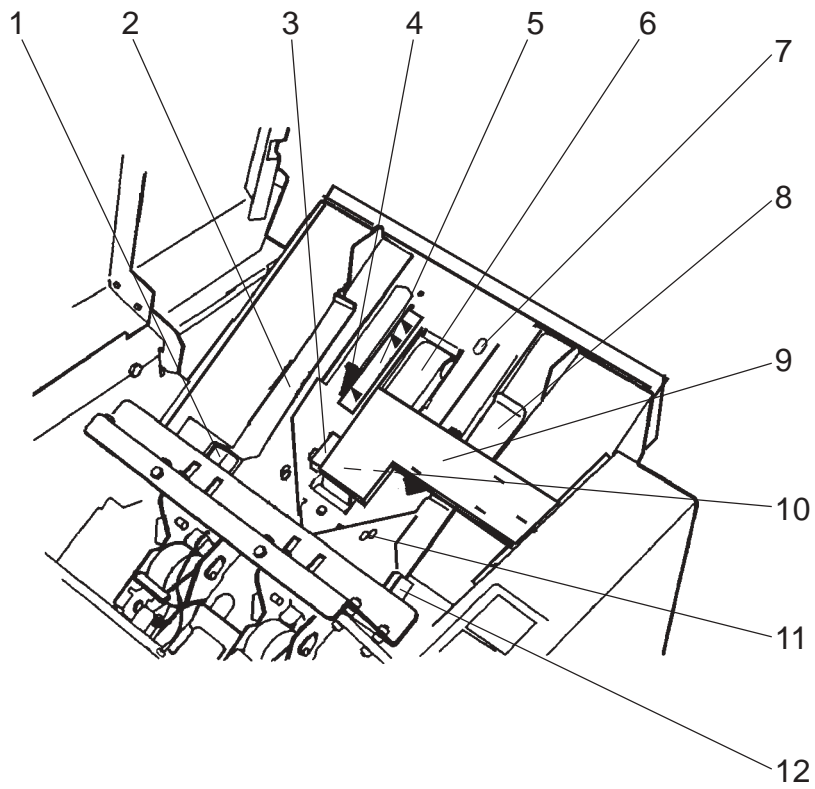

## Infeed module assembly

T07011

Item	Part no.	Qty.	Description	Note
1	75031	1	Lock, side guide	
2	751048	1	Rear Side guide assembly	
3	75161	1	Edge stapling transport arm	
	75162	1	Edge stapling transport roller	
4	75057	1	Back jogger	
5	75365	1	Scale	A4/A3 machines.
	75366	1	Scale	8.5x11"/11x17" machines.
6	750171	1	Infeed Transport belt assembly	Incl. 75089, 75066, 75064
	75089	1	Infeed trasport belt	
	75066	1	Drive roller	
	75064	1	Roller	
7	750204	1	Infeed sensor assembly	SEN 5
8	751049	1	Front Side guide assembly	
9	750157	1	Pressure arm assembly	Incl. 75346, 751050, Item 3, 10
	75346	1	Pressure arm	
	751050	1	Upper pressure roller assembly	
10	751025	1	Edge stapling transport motor assy.	MOT 6
11	88248	1	Ball	
12	75032	1	Lock, side guide	
13	60751	2	Spring	
	75203	2	Sleeve	8 x 34 mm.
14	75046	1	Shaft	
16	751008	1	Rear side guide release solenoid	SOL 3 Incl. 75034
17	75034	1	Solenoid latch	
	75030	1	Brass bracket	
18	60508	1	Flange bushing	
	751026	1	Bracket assembly, release solenoid	Incl. 60508
19	75088	1	Spring	
20	60852	3	Collar	
21	75047	1	Shaft	
22	75246	1	Spring	
23	750155	1	Length adjustment strap	
24	750118	1	Roller	
25	75342	1	Back jogger housing	
26	75045	1	Drive coupling	
27	750117	1	Back jogger motor assembly	MOT 5
28	750114	1	Infeed transport belt motor	MOT 7 Incl. Bracket

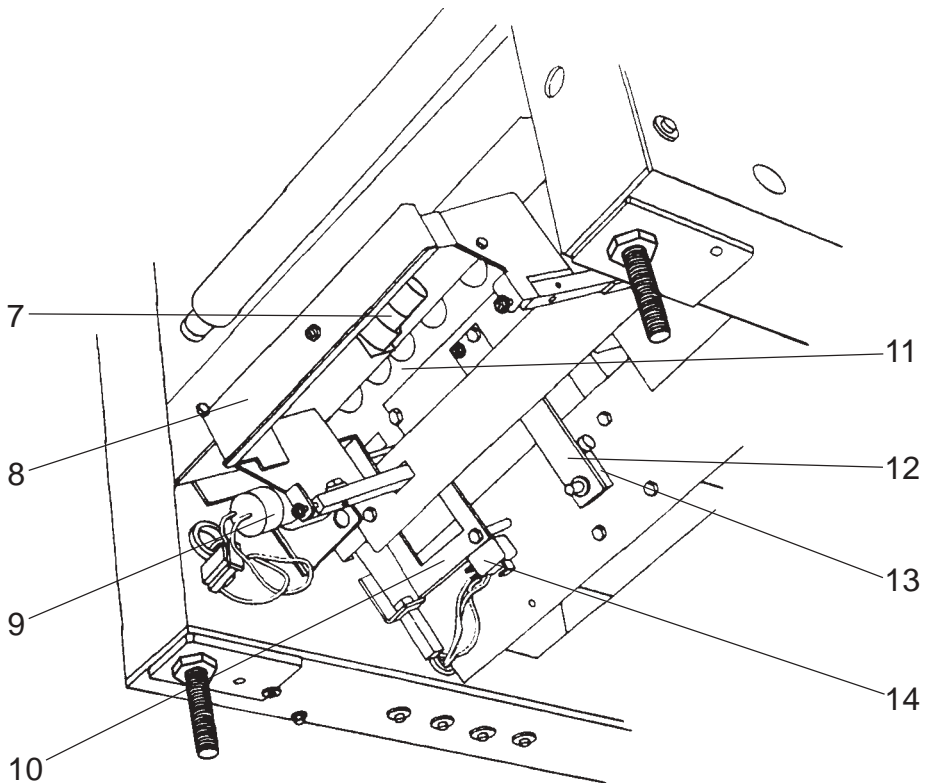
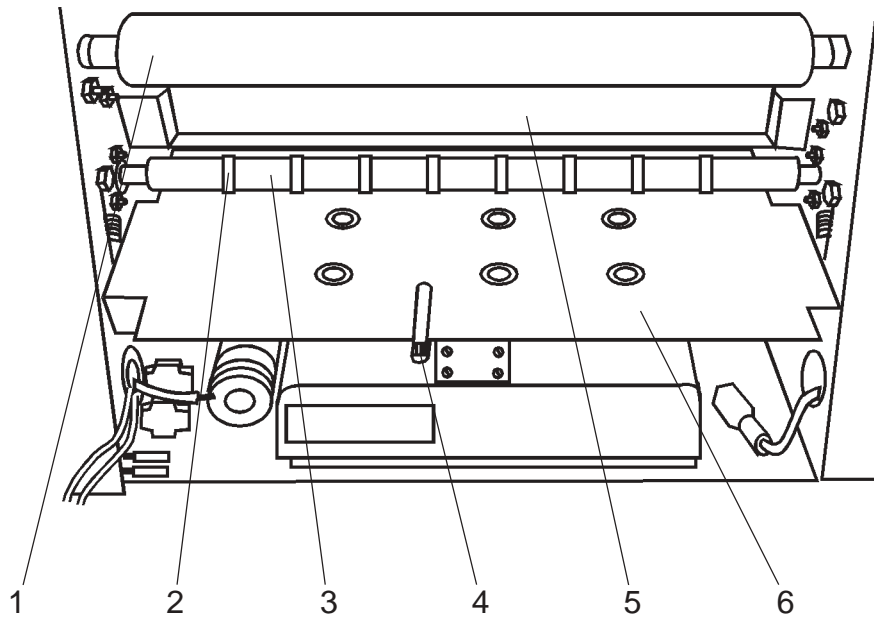

## Fold area

---

T07011

<b>Item</b>	<b>Part no.</b>	<b>Qty.</b>	<b>Description</b>	<b>Note</b>
1	600125	2	Upper folder roll	
2	60681	16	Rubber ring	
3	751052	2	Lower folder rolls assembly	Incl. Item 2
4	750204	1	Fold stop sensor assembly	SEN 2
5	60740	2	Guide plate	
6	75113	1	Lower paper path	
8	750160	1	Fold stop gate motor assembly	MOT 11
8	75112	1	Fold stop gate	
9	751036	1	Length adjustment motor	MOT 3
10	75269	1	Fold knife plate	
11	75021	1	Fold knife blade	
12	60505	1	Rod	
13	60504	1	Crank elbow	
14	751038	1	Fold knife home position switch assy.	SW 2

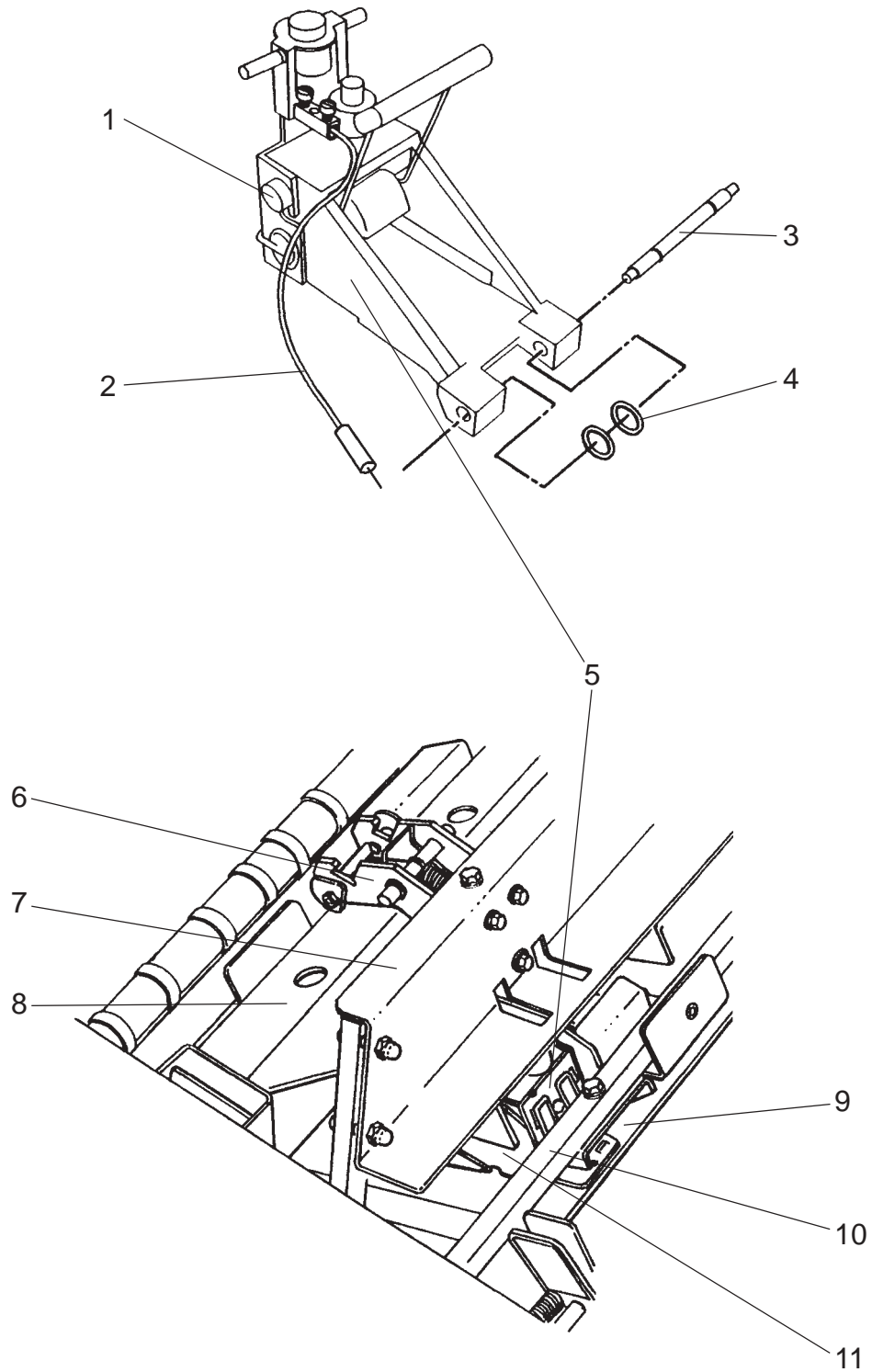

## Stapler

T07011

---

Item	Part no.	Qty.	Description	Note
1	88461	4	Insulator	
2	880156	2	Staple detection lead assembly	
3	751034	2	Pivot pin assembly	Incl. Item 4
4	75226	4	O-Ring	
5	881055	2	Stapler head assembly	Incl. Item 1, 2
6	750147	2	Retraction swing arm assembly	Incl. 75225, 75243
	75225	2	Torsion spring	
	75243	2	Spring	
7	75013	1	Upper stapler bar	
8	75018	1	Stapler mounting bracket	
	751020	1	Saddle stapling sensor assembly	SEN 1
	87006	2	Tire, drive rollers	
9	750169	1	Staple forming bar assembly	Incl. 75180, 75104
	75180	2	Anvil	
	75104	1	Edge stapling sensor	SEN 3
10	75213	1	Stapler mounting bar	
11	750156	2	Stapler bracket assembly	

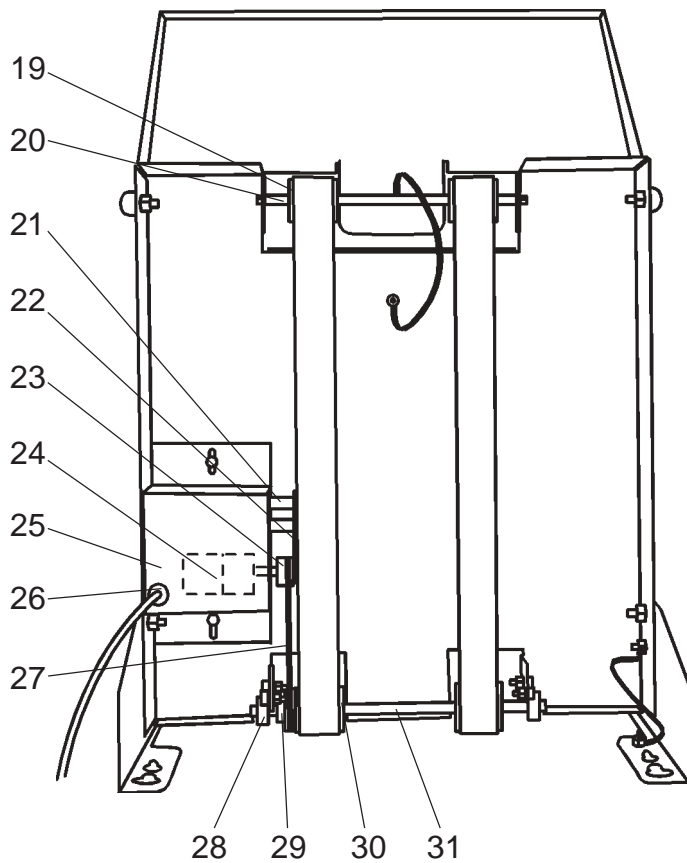
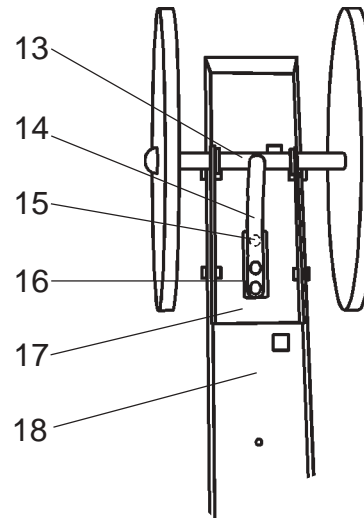
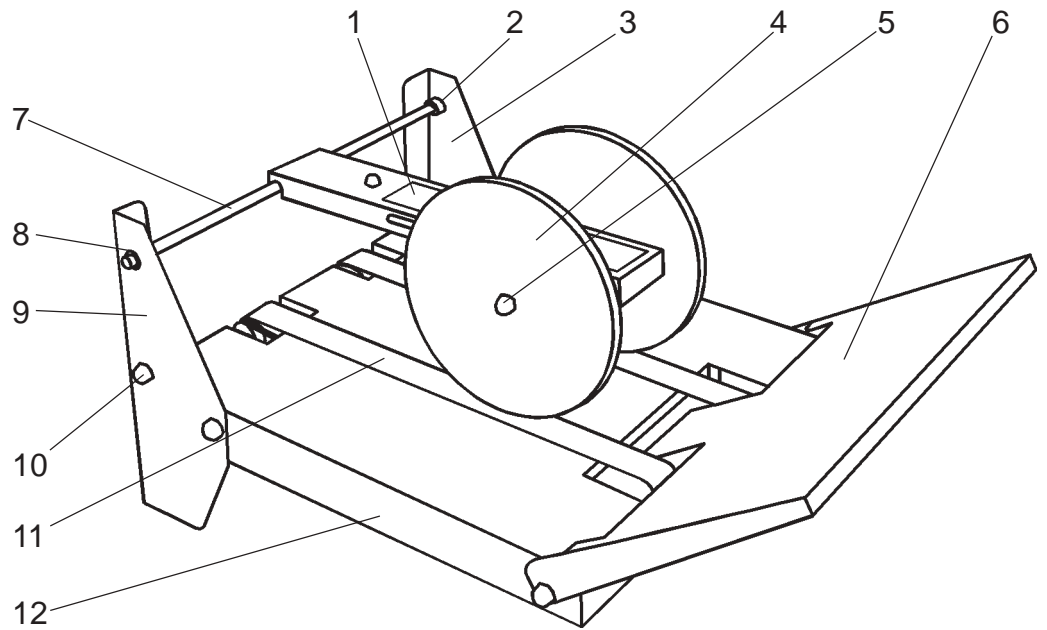

## Belt stacker

T07011

Item	Part no.	Qty.	Description	Note
1	75363	1	Label, stacker	A4/A3 Machines
	75364	1	Label, stacker	8.5x11"/11x17" Machines
2	88528	1	Spring	
3	75073	1	Mounting bracket, front	
4	88407	2	Output wheel	
5	22570	2	Plastic cap	
6	88514-26	1	End plate	
7	75075	1	Shaft	
8	80557	12	Retaining ring	
9	75074	1	Mounting bracket, rear	
10	88253	6	Plastic cap	
11	75176	2	Conveyor stacker belt	
12	75070	1	Stacker frame	
13	75076	1	Shaft	
14	75116	1	Sliding contact	
15	88248	1	Ball	
16	75099	1	Leaf spring, ball	
17	75072	1	Bracket, output wheel	
18	75071	1	Pressure arm	
19	36501	2	Roller	
	60627	4	Needle roller bearing	
20	88349	1	Shaft	
	880148	1	Shaft assembly	Incl. Item 8, 18, 19
21	22599	2	Spacer	
22	88296	1	Brass bearing support	
23	88955	1	Drive pulley	
24	750109	1	Stacker motor	MOT 1
25	88307	1	Cover, stacker motor	
26	80982	1	Grommet	
27	88214	1	V-belt	
28	60827	2	Ball bearing	
29	60812	1	Pulley	
30	88474	2	Drive roller	
31	88348	1	Drive shaft	
	880147	1	Drive shaft assembly	Incl. Item 8, 25-28